

INSTALLATION INSTRUCTIONS

Installation

Installation options

- **Free-standing**
- **Undercounter**

The machine can be installed under a continuous counter or sink drain. The recess must be at least 23 ⁵/₈" (60 cm) wide, 23 ⁵/₈" (60 cm) deep and 32 ¹/₄" (82 cm) high.

Installation

 Furniture and fittings installed near the machine must be of a commercial standard (able to withstand the effects of steam).

- Please refer to the installation diagram supplied with the machine.

Leveling the machine

- The dishwasher needs to stand even. It can be leveled with the four height adjustable feet.

Positioning and securing the machine

To ensure stability for undercounter installations, the machine must be aligned and screwed to the counter.

- Open the door.
- Secure the machine to the front edge of the countertop using screws to the left and right of the front trim.
- When not mounted undercounter, floor mounting brackets must be used.

Do not use silicone sealant to seal the gaps between the machine and any neighboring units.

Steam Deflector (protects the countertop)

Depending on the requirements for an undercounter installation, a steam deflector can be ordered from the Miele Technical Service Department.

The underside of the countertop is protected from steam damage by this stainless steel plate.

Removing the lid (if necessary)

If necessary, remove the lid from the machine to make installation possible.

- Open the door.

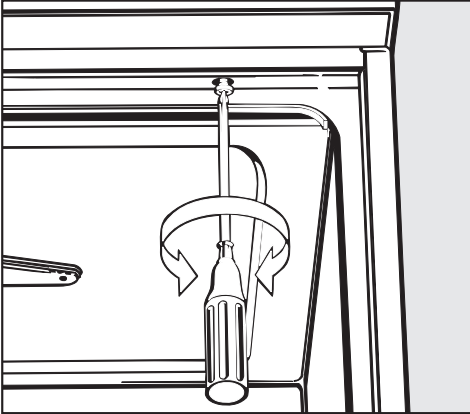

- Remove the fixing screws on the left and right sides using a Phillips head screwdriver.
- Pull the machine lid approx. 5 mm forwards, lift it upwards and remove.

Electrical connection

 All electrical work must be carried out by a suitably qualified person in compliance with local and national safety regulations.

The machine comes equipped for connection to a 208 V, 60 Hz, 3 phase power supply. It is supplied with a 6 ft., 12/4 AWG power cord, without a plug. A plug, rated for the required power which will fit the receptacle, is to be supplied by the electrician doing the installation. It should be connected to the main power supply according to national requirements.

Voltage: 208 V, 3 phase

Frequency: 60 Hz

Rated Load: 6.2 kW

Circuit breaker: 3 x 20 A

Black : connect to L1 (hot)

Red: connect to L2 (hot)

White: connect to L3 (hot)

Green: connect to GND (ground)

It can be converted to use a single phase power supply in accordance with the conversion and wiring diagram. The cord must be changed from a 12/4 AWG to a 10/3 AWG. Contact Miele Technical Service for more information

Voltage: 208 V, 1 phase

Frequency: 60 Hz

Rated Load: 6.2 kW

Circuit breaker: 2 x 30 A

- A damaged power cord must only be replaced with a genuine Miele cord by a Miele Service Technician.

WARNING **THIS APPLIANCE MUST BE GROUNDED**

Grounding the machine

A connection screw with the grounding symbol () is provided on the back of the machine for grounding.

 All electrical work must be performed by a qualified person in accordance with local and national safety regulations.

The machine is equipped with a 6 ft., 12/4 AWG power cord, without a plug. A plug, rated for the required power which will fit the receptacle, is to be supplied by the electrician doing the installation. It should be connected to the main power supply according to national requirements.

- For technical data see the data plate or wiring diagram supplied.

The machine must only be operated with the voltage, frequency and fusing shown on the **data plate**.

The **data plate** is located on the rear of the machine and behind the service panel on the upper left side.

- A damaged power cord must only be replaced with a genuine Miele cord by a Miele Service Technician.

The dishwasher can be **converted** according to the supplied **converting diagram** and **wiring diagram**.

The **wiring diagram** is located behind the operating panel.

The **conversion diagram** is located behind the service panel.

- See also the installation diagram supplied.

WARNING **THIS APPLIANCE MUST BE GROUNDED**

Grounding the machine

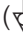
A connection screw with the grounding symbol () is provided on the back of the machine for grounding.

Plumbing

Water inlet

 Water in the machine is not suitable for drinking.

- The machine must be connected to the water supply in accordance with local and national regulations.
- The washer is constructed so it may be connected to a water supply without an extra non-return valve, unless required by code.
- Water in certain regions shows precipitations. In this case the machine must only be used with a water softener unit.
- The water pressure must be at least 14.5 psi.
If the water pressure is below 14.5 psi, the water intake time lengthens. The max. permitted static pressure is 145 psi. If the water pressure (flow pressure) is not between 14.5 and 145 psi, contact Miele's Technical Service Dept.. The indicator  - Fault code "F2E" may light.
- The machine is supplied to be connected to a standard cold **or** hot water supply at a maximum temperature of 149 °F (65 °C).

- A water valve with $\frac{3}{4}$ " male hose thread is to be provided on site. It should be easily accessible so the water supply can be turned off when the machine is not in use.
- The inlet hose is 5 $\frac{1}{2}$ feet (1.7 m) long, with a $\frac{3}{4}$ " (2 cm) female hose thread. An extension hose is available (4 ft. 11 " [1.5 m] flexible metal hose, 2.03 psi pressure). **The water inlet filters in the threads must not be removed.**
- The large surface area filter (supplied in the accessory bag with the machine) must be installed between the water supply and the inlet hose. See "Cleaning the water inlet filters".

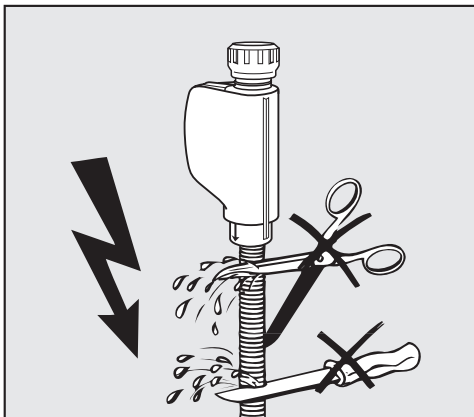

 Do not cut the inlet hose or damage it in any way.

- See also the installation diagram supplied.

Drainage

- The drain hose is equipped with a non-return valve which prevents waste water from flowing back into the machine.

- The machine should preferably be connected to a **separate** drainage system onsite.

If separate drainage is not available contact your Miele application specialist for advice.

The onsite drain connection point should be located between 1 ft.

(0.3 m) and 3 ft. (1 m) **above the lower edge of the machine.**

If it is lower than 1 ft. (0.3 m), bend the hose in a curve at a height of at least 1 ft. (0.3 m).

The drainage system must be able to take a minimum drainage flow of 4.5 gal/min (16 l/min).

- The flexible drain hose is 4' 7" (1.4 m) long and has an internal diameter of $\frac{7}{8}$ " (22 mm). Do not cut the drain hose.

Hose clamps are supplied for securing it in position.

- A longer drain hose (up to 13 ft. [4 m] long) is available to from Miele.

- The drainage system must not exceed 13 ft. (4 meters).

- See the supplied installation diagram.

